

WISE

REAL ESTATE INC.

P.O. Box 1122 • 1242 Hwy. 150 W. • Cherryville, NC • Phone (704) 435-3060 • Fax (704) 435-1957

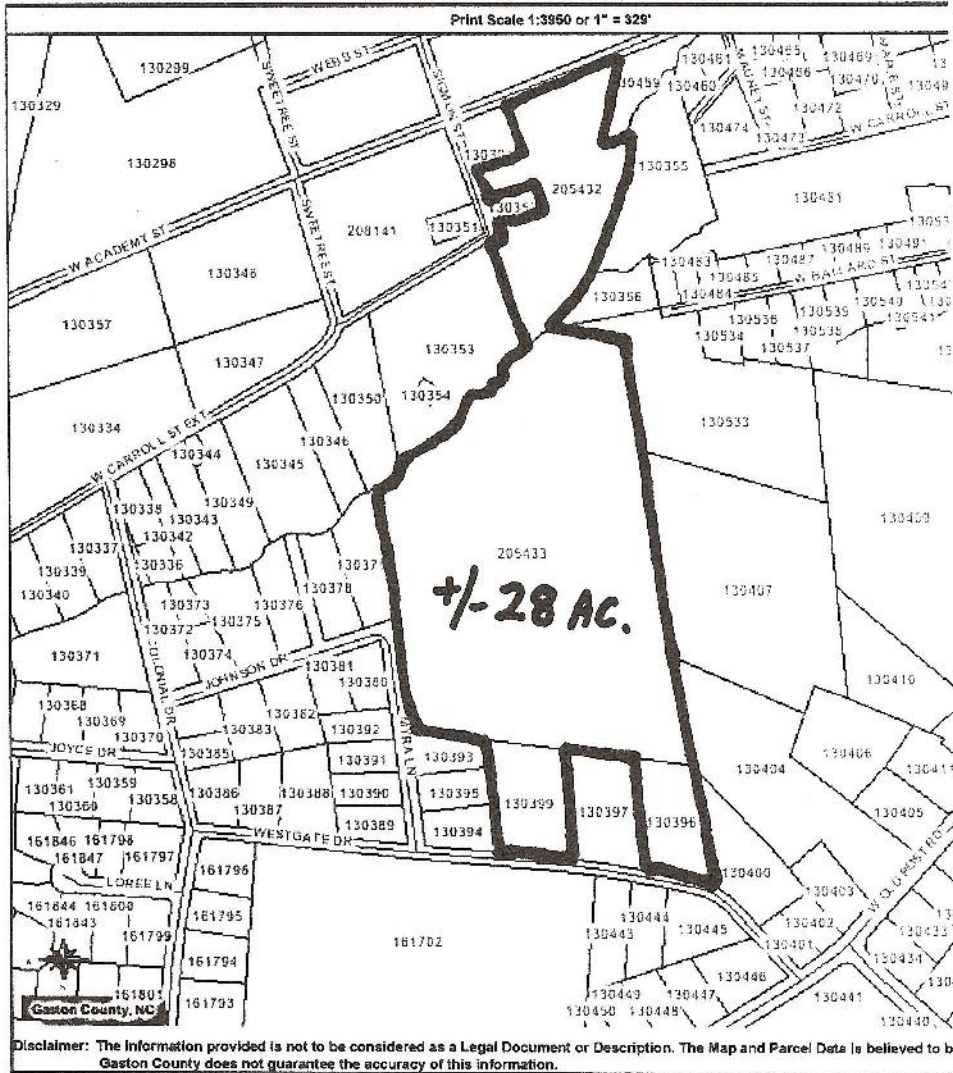

"The WISE choice for your real estate needs!"

+/- 28 Acres of Land – Parcels # 205432,205433,130396,130399(Gaston County)
 Inside City Limits of Cherryville, NC 28021
 Westgate Neighborhood Area
 Wooded (Hardwood & Pine)
 2 Streams
 Road Frontage on 4 City Streets
 Great for development or private estate!